

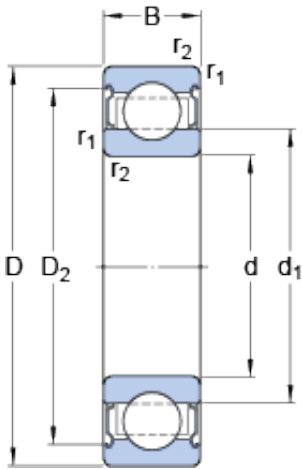

TRAY BEARING-MALAYSIA SDN.BHD.



80 mm x 140 mm x 26 mm SKF 6216-2Z/VA208 deep groove ball bearings

Bearing No. 6216-2Z/VA208

6216-2Z/VA208 Bearing 2D drawings and 3D CAD models

Size	140x80x26 mm
Bore Diameter	140 mm
Outer Diameter	80 mm
Width	26 mm
d	80 mm
D	140 mm
B	26 mm
d ₁	101.4 mm
D ₂	126.5 mm
r _{1,2} - min.	2 mm
d _a - min.	91 mm
d _a - max.	100.9 mm
D _a - max.	129 mm
r _a - max.	2 mm
Basic dynamic load rating - C	72.8 kN
Basic static load rating - C ₀	55 kN
Limiting speed	40 r/min
Limiting temperature - T	350 ° C
Category	Single Row Ball Bearings
Inventory	0.0
Manufacturer Name	SKF
Minimum Buy Quantity	N/A
Weight / Kilogram	1.54
EAN	7316570749014



TRAY BEARING-MALAYSIA SDN.BHD.

Product Group	B00308
Enclosure	2 Metal Shields
Precision Class	ABEC 1 ISO P0
Maximum Capacity / Filling Slot	No
Rolling Element	Ball Bearing
Snap Ring	No
Internal Special Features	Segmented Cage
Cage Material	Graphite
Internal Clearance	C0-Medium
Inch - Metric	Metric
Long Description	80MM Bore; 140MM Outside Diameter; 26MM Outer Race Width; 2 Metal Shields; Ball Bearing; ABEC 1 ISO P0; No Filling Slot; No Snap Ring; Segmented Cage Internal Special Features; C0-Medium Internal Cl
Other Features	Deep Groove Extreme Temperature Variant
Category	Single Row Ball Bearing
UNSPSC	31171504
Harmonized Tariff Code	8482.10.50.68
Noun	Bearing
Keyword String	Ball
Manufacturer URL	http://www.skf.com
Manufacturer Item Number	6216-2Z/VA208
Weight / LBS	1.55
Outside Diameter	5.512 Inch 140 Millimeter
Inner Race Width	0 Inch 0 Millimeter
Outer Race Width	1.024 Inch 26 Millimeter
Bore	3.15 Inch 80 Millimeter
bore diameter:	80 mm



TRAY BEARING-MALAYSIA SDN.BHD.

precision rating:	Not Rated
outside diameter:	140 mm
finish/coating:	Uncoated
overall width:	26 mm
cage material:	Graphite
bore type:	Round
outer ring width:	26 mm
closure type:	Double Shielded
fillet radius:	2 mm
row type & fill slot:	Single Row Non-Fill Slot
maximum rpm:	40 RPM
internal clearance:	C0
series:	62
operating temperature range:	-240 to +660 ° F
resistance features:	Corrosion Resistant, Extreme Temperature
static load capacity:	55 kN
d_1	101.4 mm
D_2	126.5 mm
$r_{1,2}$ min.	2 mm
d_a min.	91 mm
d_a max.	100.9 mm
D_a max.	129 mm
r_a max.	2 mm
Basic dynamic load rating C	72.8 kN
Basic static load rating C_0	55 kN
Limiting temperature T max.	350 ° C
Mass bearing	1.53 kg