

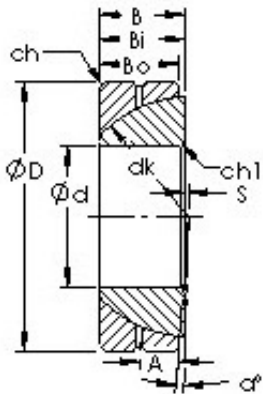

TRAY BEARING-MALAYSIA SDN.BHD.



GAC30S Bearing 2D drawings and 3D CAD models

AST GAC30S plain bearings

Bearing No. GAC30S

| | |
|---|-----------------------------------|
| Size | 30x55x17 mm |
| Bore Diameter | 30 mm |
| Outer Diameter | 55 mm |
| Width | 17 mm |
| Bearing Type - steel-on-steel | steelonsteel |
| Bore Dia (d) | 30.0000 |
| Outer Dia (D) | 55.0000 |
| Width (B) | 17.0000 |
| Outer Width (Bo) | 15.0000 |
| Inner Width (Bi) | 17.0000 |
| Dynamic Load Rating (Cr) | 63,000 |
| Static Load Rating (Cor) | 315,000 |
| Max. shaft corner radius, or 45 deg. chamfer (ch1) | 1.000 |
| Max. housing corner radius, or 45 deg. chamfer (ch) | 1.000 |
| Spherical Diameter (dk or Dk) | 49.500 |
| Mis-alignment Angle (a deg.) | 4.5 |
| Lubrication Groove Location (A) | 8.500 |
| Spherical Center Location (S) | 1 |
| Weight (g) | 208.00 |
| Material | 52100 Chrome steel, or equivalent |