

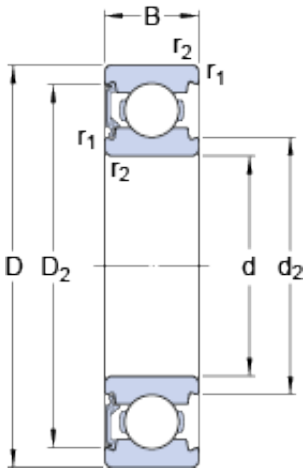

TRAY BEARING-MALAYSIA SDN.BHD.



17 mm x 40 mm x 12 mm SKF 6203-RSL deep groove ball bearings

Bearing No. 6203-RSL

6203-RSL Bearing 2D drawings and 3D CAD models

Size	40x17x12 mm
Bore Diameter	40 mm
Outer Diameter	17 mm
Width	12 mm
d	17 mm
D	40 mm
B	12 mm
d ₂	21.75 mm
D ₂	34.98 mm
r _{1,2} - min.	0.6 mm
d _a - min.	21.2 mm
d _a - max.	22 mm
D _a - max.	35.8 mm
r _a - max.	0.6 mm
Basic dynamic load rating - C	10 kN
Basic static load rating - C ₀	4.8 kN
Fatigue load limit - P _u	0.2 kN
Reference speed	38000 r/min
Limiting speed	24000 r/min
Calculation factor - k _r	0.025
Calculation factor - f ₀	13
d ₂	21.75 mm
D ₂	34.98 mm
d _a min.	21.2 mm



TRAY BEARING-MALAYSIA SDN.BHD.

d_a max.	22 mm
D_a max.	35.8 mm
r_a max.	0.6 mm
Basic dynamic load rating C	9.95 kN
Basic static load rating C_0	4.75 kN
Fatigue load limit P_u	0.2 kN
Calculation factor k_r	0.025
Calculation factor f_0	13
Mass bearing	0.067 kg