

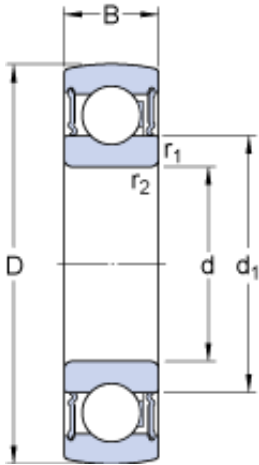

TRAY BEARING-MALAYSIA SDN.BHD.



50 mm x 90 mm x 20 mm SKF 1726210-2RS1
deep groove ball bearings

Bearing No. 1726210-2RS1

1726210-2RS1 Bearing 2D drawings and 3D CAD models

Size	90x50x20 mm
Bore Diameter	90 mm
Outer Diameter	50 mm
Width	20 mm
d	50 mm
D	90 mm
B	20 mm
d ₁	62.51 mm
r _{1,2} - min.	1.1 mm
Basic dynamic load rating - C	35.1 kN
Basic static load rating - C ₀	23.2 kN
Fatigue load limit - P _u	0.98 kN
Limiting speed	4800 r/min
Calculation factor - f ₀	14
Category	Insert Bearings Spherical OD
Inventory	0.0
Manufacturer Name	SKF
Minimum Buy Quantity	N/A
Weight / Kilogram	0.41
EAN	7316577742933
Product Group	M06110
Inner Race Profile	Standard Inner Ring
Outer Race Profile	Spherical



TRAY BEARING-MALAYSIA SDN.BHD.

Relubricatable	No
Seal Type	RS1 Seal
Mounting Method	Shaft Mount
Rolling Element	Ball Bearing
Snap Ring	No
Long Description	50MM Bore; Standard Inner Ring; Ball Bearing; 20MM Length Thru Bore; 20MM Outer Race Width; 90MM Outside Diameter; Not Relubricatable; RS1 Seal Seal; Shaft Mount Mounting Method; No Snap Ring
Inch - Metric	Metric
Other Features	Single Row Standard Duty Metric
Category	Insert Bearings
UNSPSC	31171536
Harmonized Tariff Code	8482.10.50.00
Noun	Bearing
Keyword String	Insert
Manufacturer URL	http://www.skf.com
Manufacturer Item Number	1726210-2RS1
Weight / LBS	0.904
Bore	1.969 Inch 50 Millimeter
Length Thru Bore	0.787 Inch 20 Millimeter
Outer Race Width	0.787 Inch 20 Millimeter
Outside Diameter	3.543 Inch 90 Millimeter
bore diameter:	50 mm
radial static load capacity:	23.2 kN
outside diameter:	90 mm
finish/coating:	Uncoated
outer ring width:	20 mm
maximum rpm:	4300 RPM
bore type:	Round



TRAY BEARING-MALAYSIA SDN.BHD.

seal type:	Contact/Lip
operating temperature range:	-40 to +210 ° F
series:	17262
radial dynamic load capacity:	35.1 kN
d_1	62.51 mm
$r_{1,2}$ min.	1.1 mm
Basic dynamic load rating C	35.1 kN
Basic static load rating C_0	23.2 kN
Fatigue load limit P_u	0.98 kN
Limiting speed ¹⁾	4800 r/min
Calculation factor f_0	14
Mass complete bearing	0.44 kg